

Yunxin Campus of the Kindergarten Affiliated to Hangzhou Municipal People's Government

# 杭州市人民政府机关幼儿园运新园区 效果方案设计

2026. 04. 11

目 录

*CONTENTS*

- 1、栏杆效果
- 2、大门造型
- 3、门口台阶平面图
- 4、走道、楼梯地胶板及扶手
- 5、多功能屋顶平台
- 6、宝贝厨房
- 7、涂鸦教室
- 8、绘本教室
- 9、厨房及教职工餐厅平面尺寸图
- 10、二层弱电机房



# 01 Revised drawings

改造图纸

## 栏杆造型效果 Railing design





## 02 Revised drawings

改造图纸

### 大门造型效果 *The design of the gate*





大门造型  
*The design of the gate*

Technical drawing of a playground fence assembly, showing a semi-circular gate and two rectangular sections. The drawing includes dimensions and material specifications.

**Dimensions:**

- Gate width: 5720
- Gate height: 1150
- Rectangular section width: 2350
- Rectangular section height: 1150
- Rectangular section depth: 1600
- Rectangular section width (including gate): 5720
- Rectangular section height (including gate): 1150
- Rectangular section depth (including gate): 1600

**Material Specifications:**

- 铁灰色铁艺栏杆 (Iron grey iron railing)
- 幼儿园1000规格钢板经激光加工艺处理 (1000 specification steel plate processed by laser technology for kindergarten)
- 彩色亚克力有机玻璃 (Colorful acrylic organic glass)
- 新瑞托太阳门柱灯 (成品总样) (New Rui To Sun Gate Column Light (finished product sample))
- 50\*50\*6mm铁艺栏杆 表面浅灰色氟碳漆饰面 (50\*50\*6mm iron railing, surface light grey fluorocarbon paint finish)
- 30\*30\*6mm铁艺栏杆 表面浅灰色氟碳漆饰面 (30\*30\*6mm iron railing, surface light grey fluorocarbon paint finish)
- 105\*3mm铁艺钢板 表面浅灰色氟碳漆饰面 (105\*3mm iron plate, surface light grey fluorocarbon paint finish)
- 新瑞托太阳门柱灯 (成品总样) (New Rui To Sun Gate Column Light (finished product sample))
- 渐增墙体 (Increasing wall)

SCALE 1:40@A2

[illegible]

SCALE 1:40@A2

注：图纸均为参考尺寸，需以现场尺寸为准

门口台阶平面图  
Floor plan of the  
entrance steps

### 主入口台阶改造示意图

	实 名	签 名
项目负责入		
专业负责入		
设 计 人		
注册(执业)章		
预留章		
出图章		
审图章		
竣工章		

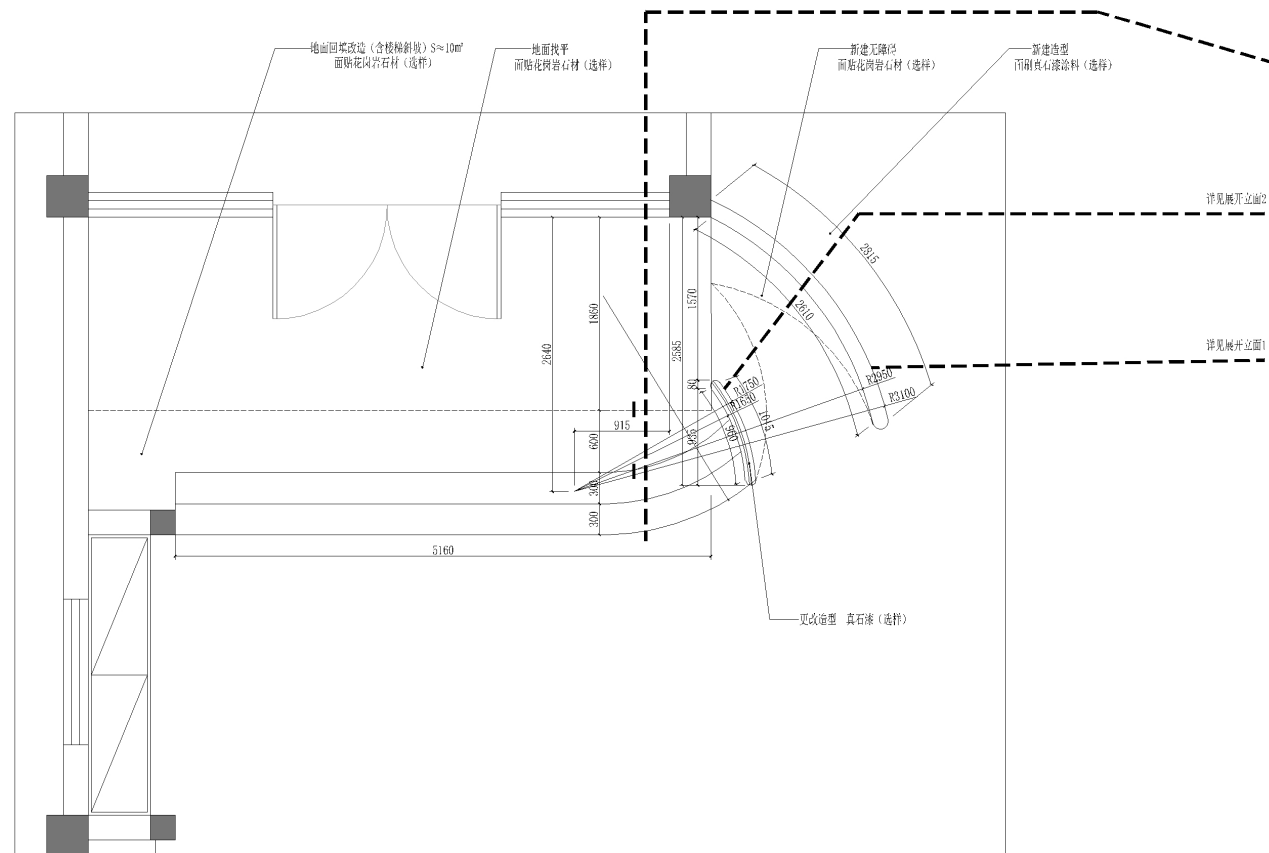

REFLECTED CEILING PLAN

主入口改造图

SCALE 1:30@A2

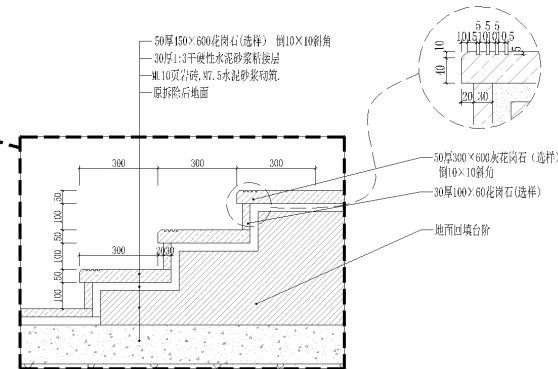

### 室外踏步节点图

1:16@A2

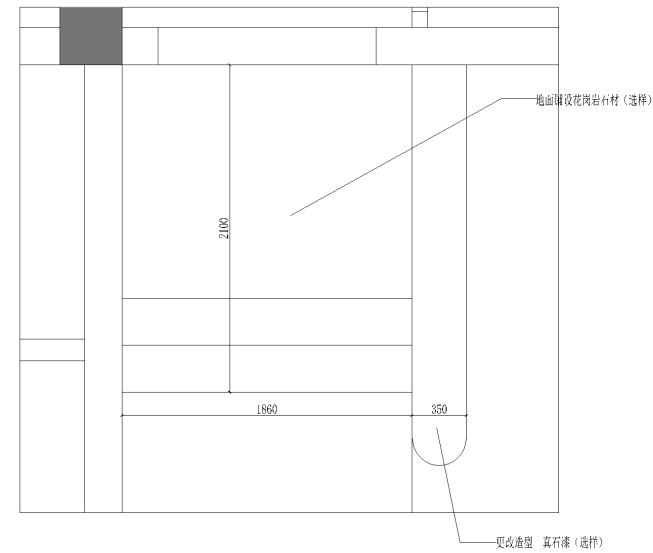

REFLECTED CEILING PLAN

### 楼梯入口改造图

SCALE 1:20@A2

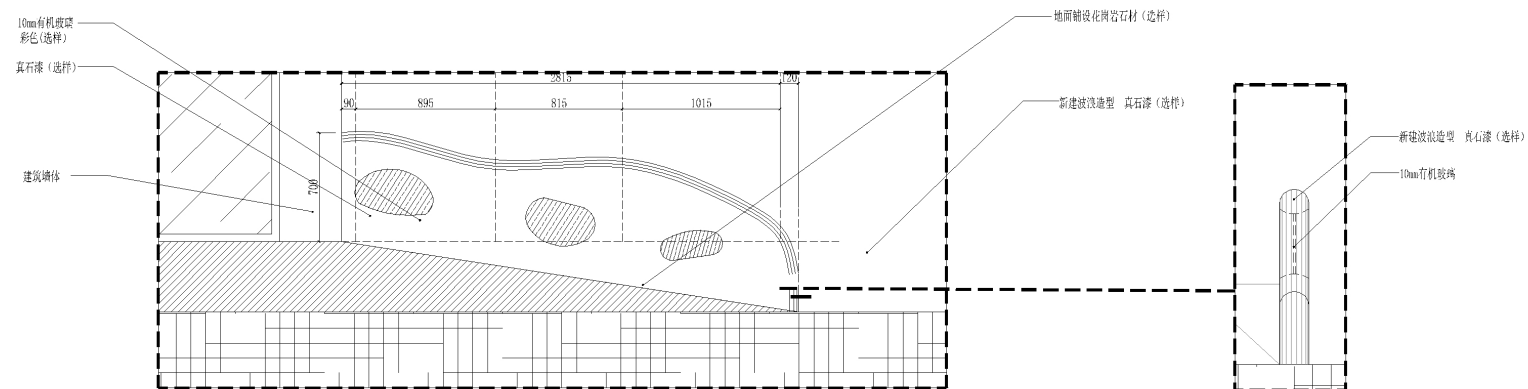

展开立面1

1:16@A2

### 走边剖面图

1:16@A2

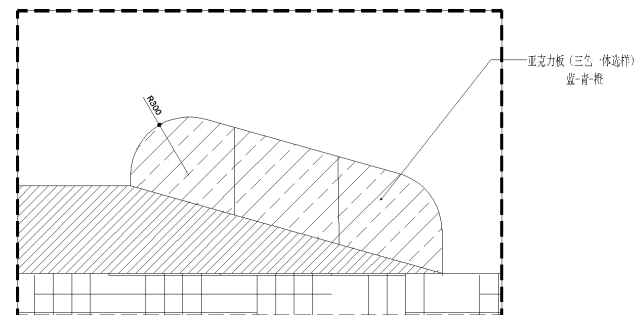

展开立面2

1:16@A2

注：图纸均为参考尺寸，需以现场尺寸为准



04

Revised drawingsRevised drawings

改造图纸

走道、楼梯地胶板及扶手

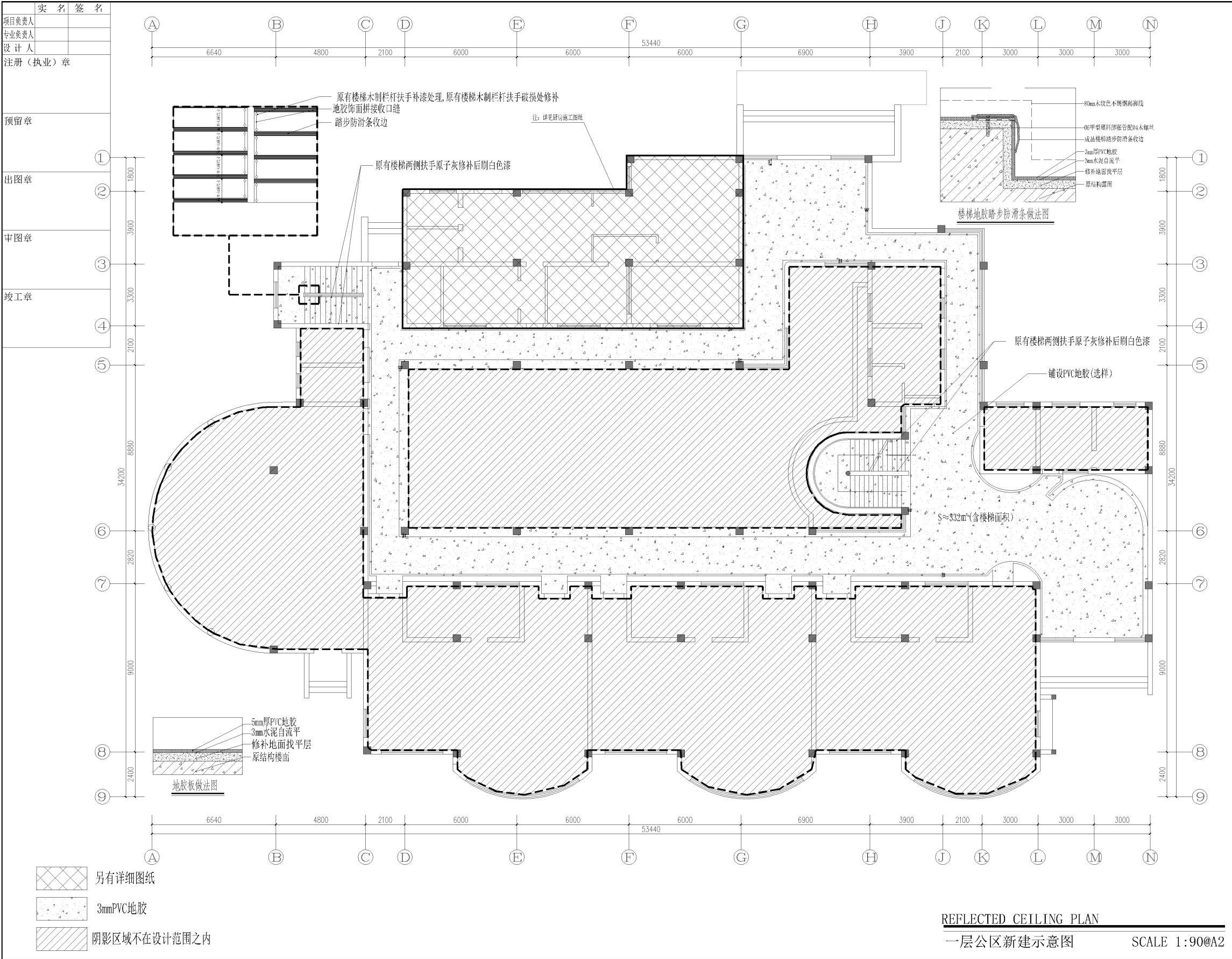

04

Revised drawingsRevised drawings

改造图纸

走道、楼梯地胶板及扶手

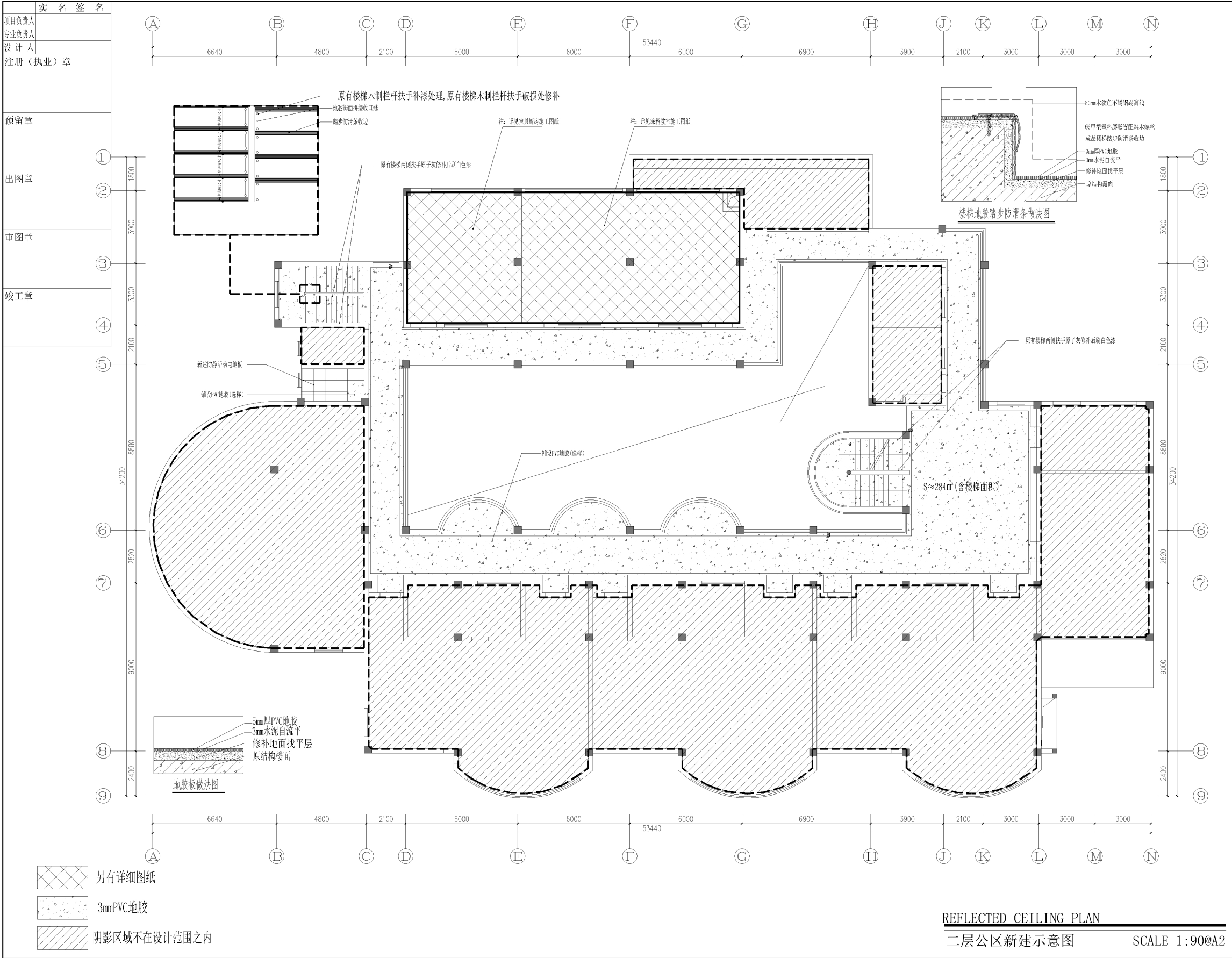

## Revised drawings

改造图纸

## 走道、楼梯地胶板及扶手

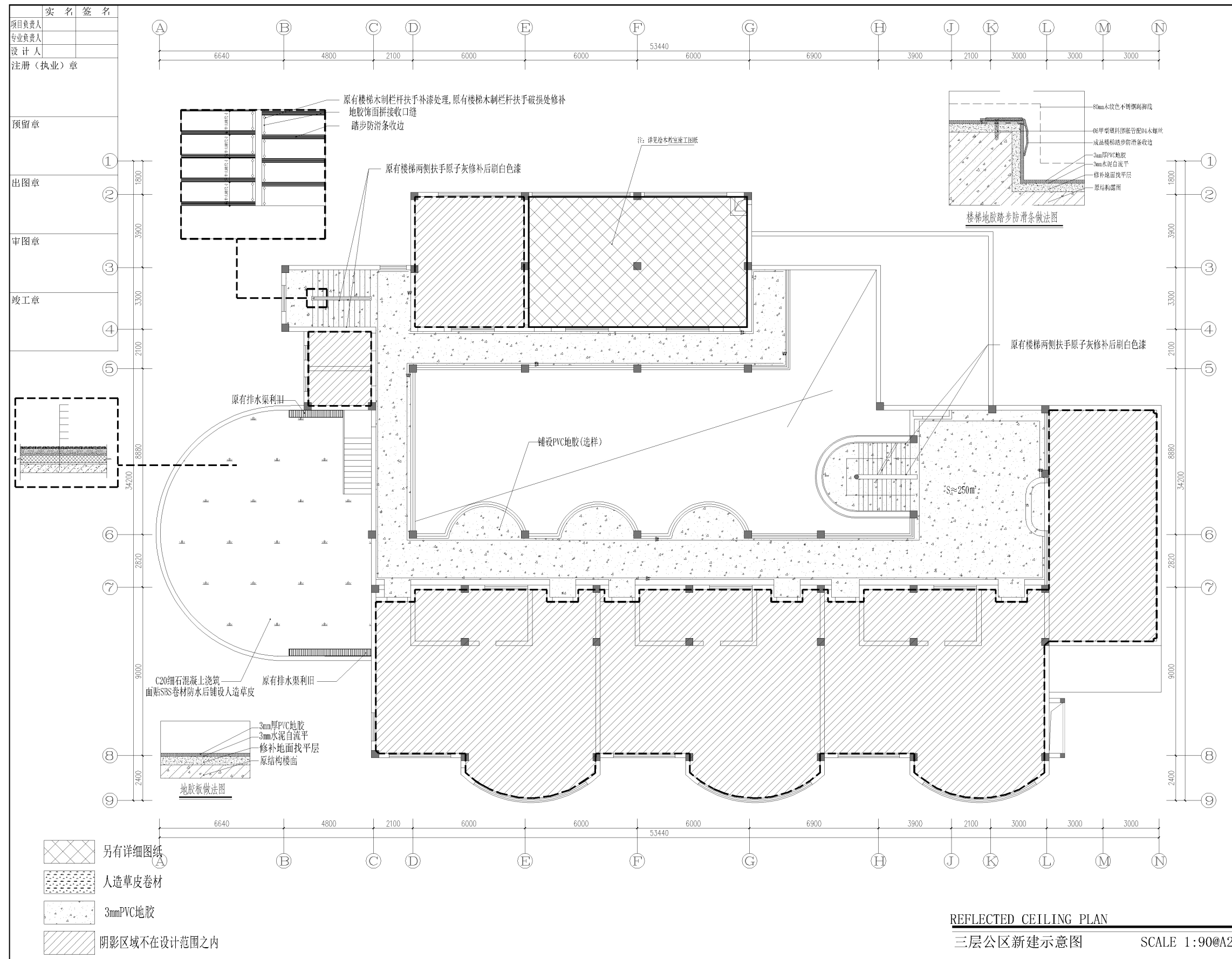



04

Revised drawingsRevised drawings

改造图纸

走道、楼梯地胶板及扶手

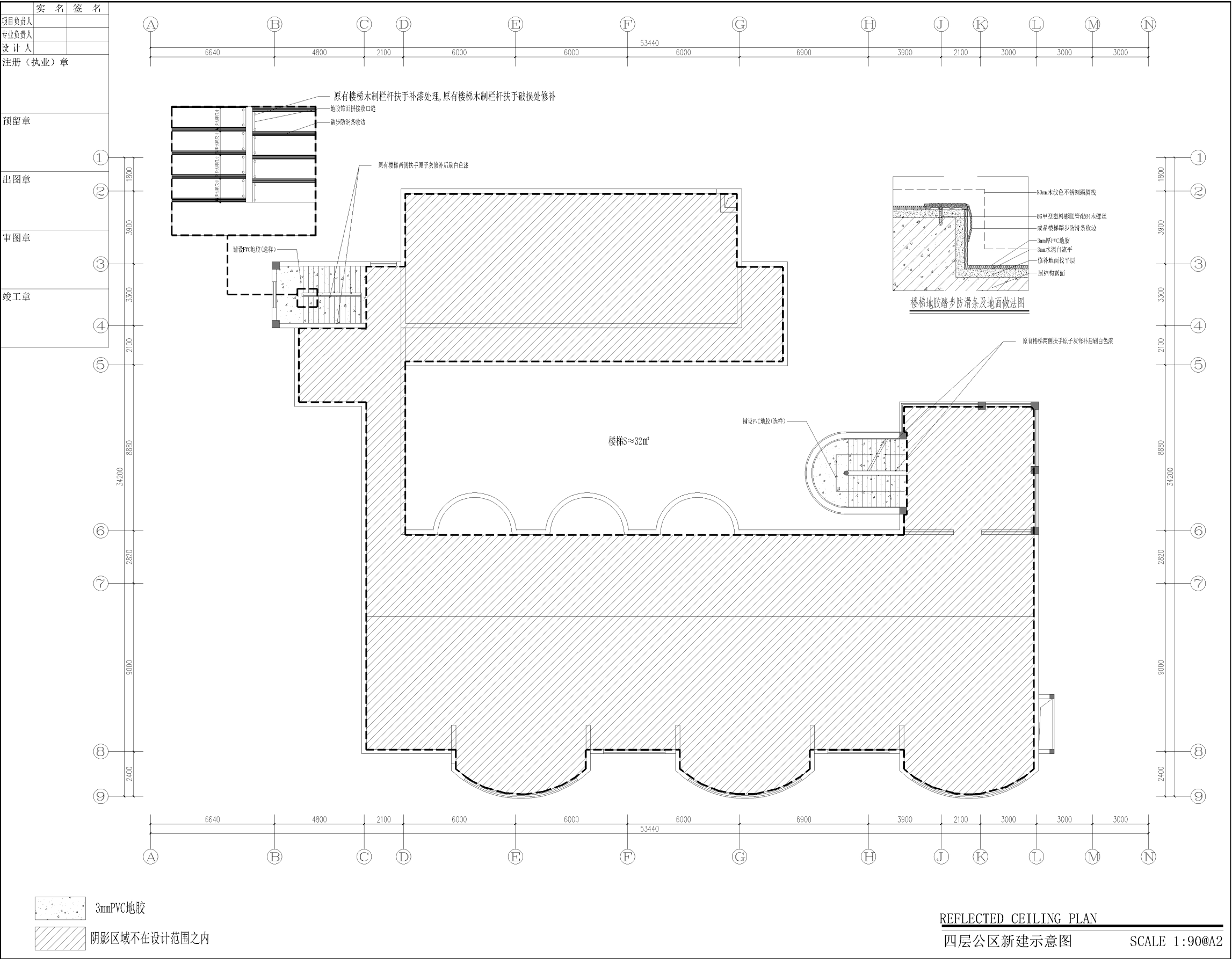

05

Revised drawingsRevised drawings

改造图纸

多功能屋顶平台

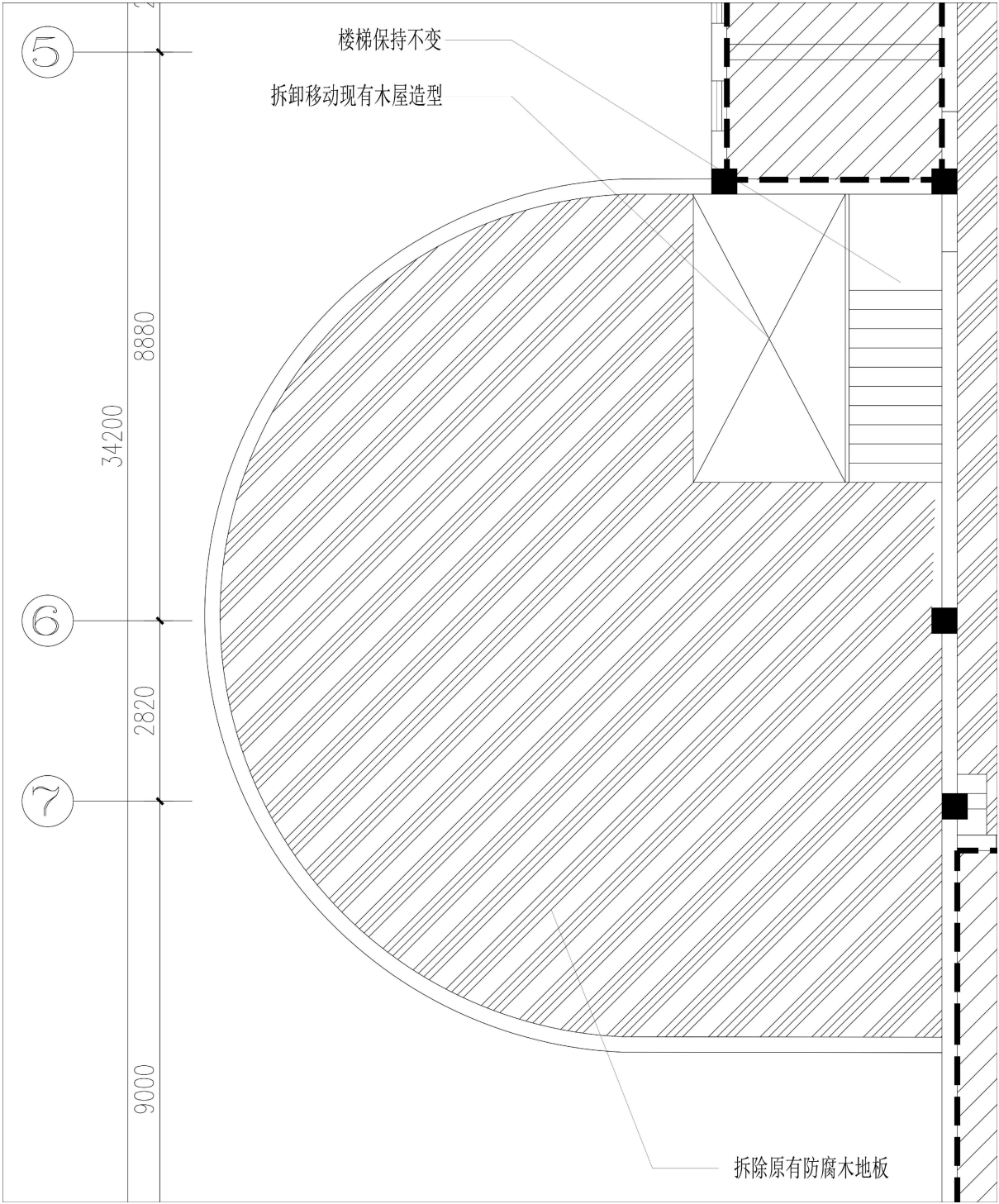

多功能屋顶平台拆除范围

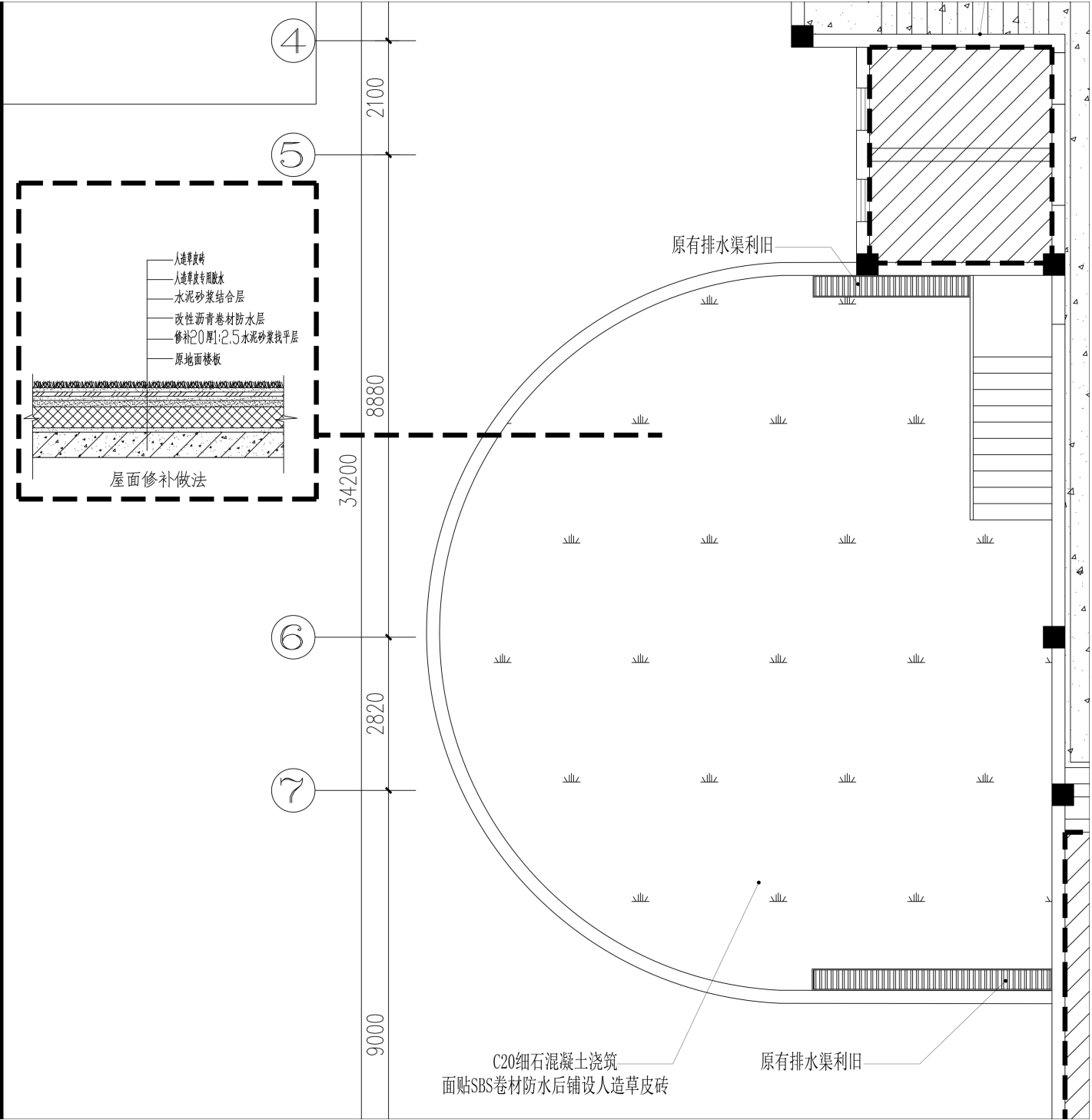

多功能屋顶平台改造材料及做法

06

Interior floor plan

宝贝厨房室内平面方案

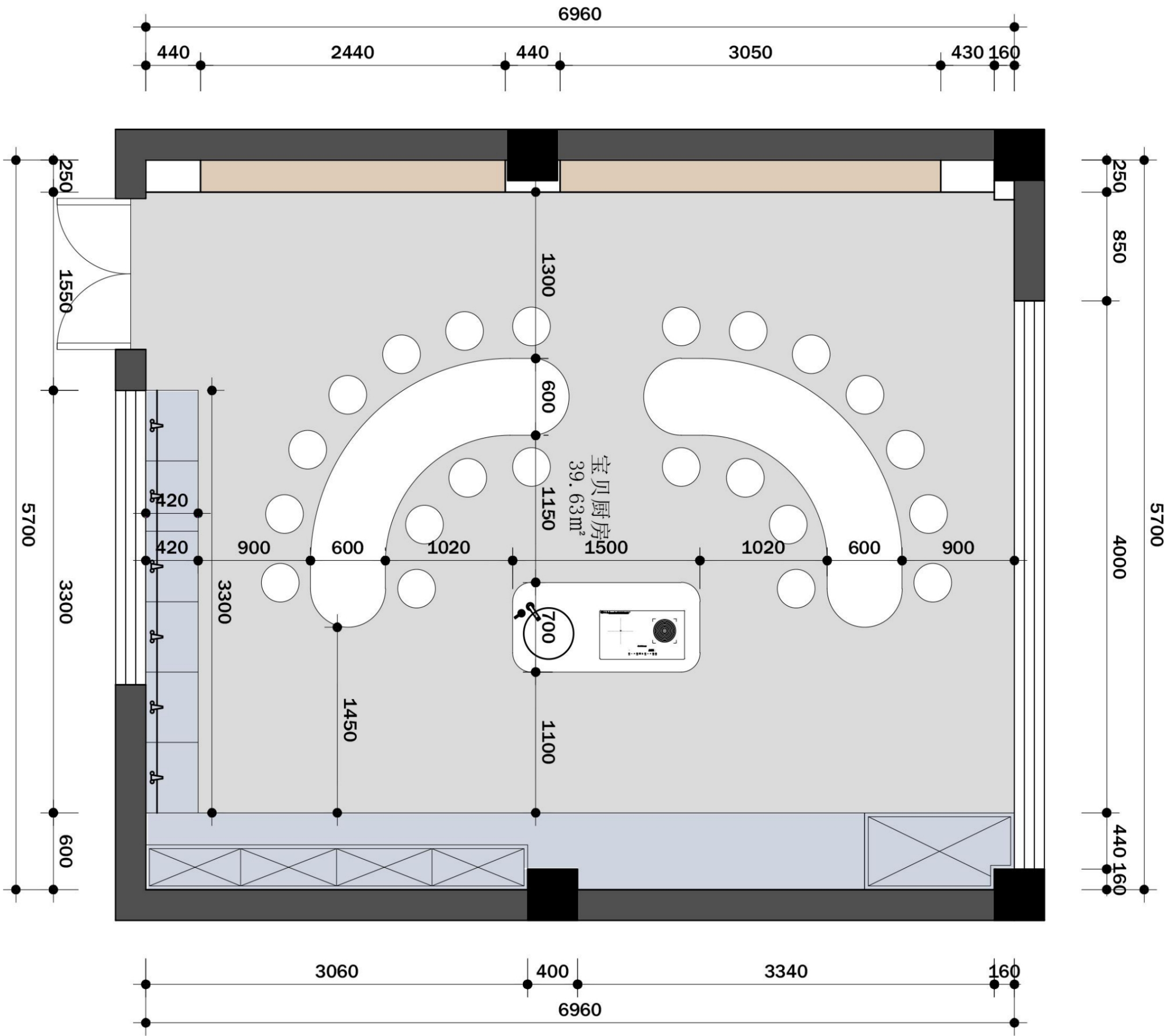

## 06 In do oreffect

宝贝厨房  
*Baby Kitchen*

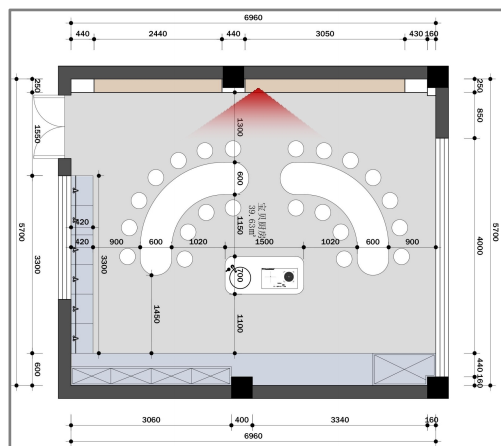



06

In do oreffect

室内效果

宝贝厨房

Baby Kitchen

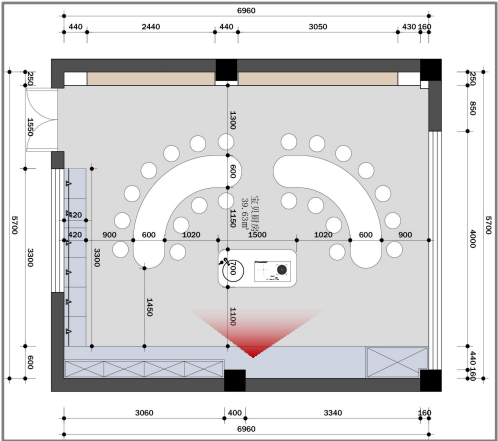



07

Interior floor plan

涂鸦教室室内平面方案

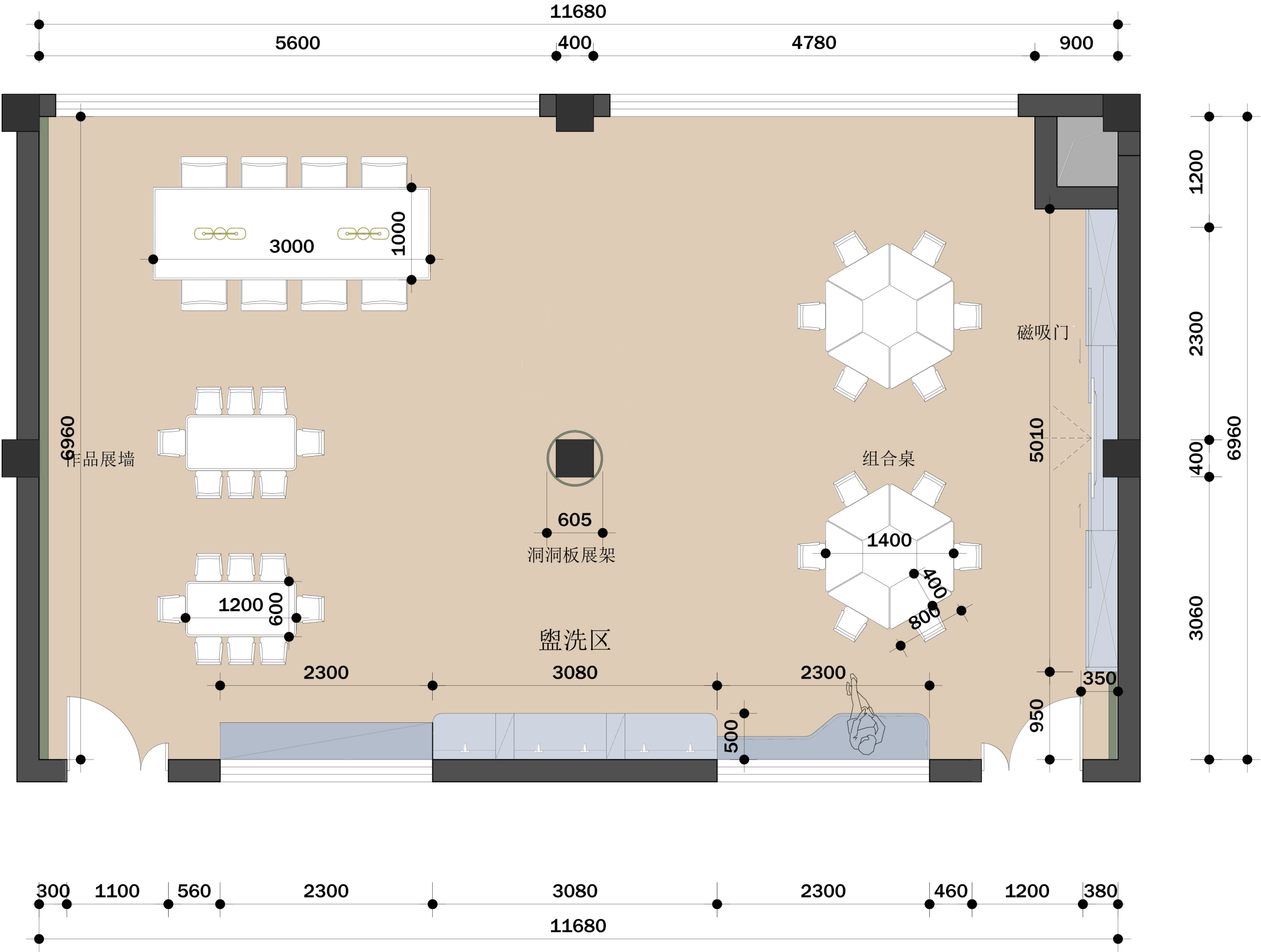



## 07 In do oreffect

涂鸦教室  
Doodle Classroom

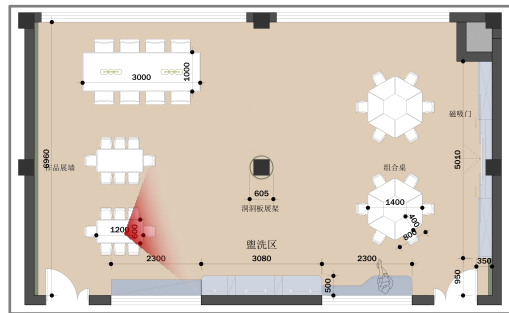



07 In do oreffect  
室内效果

涂鸦教室  
Doodle Classroom

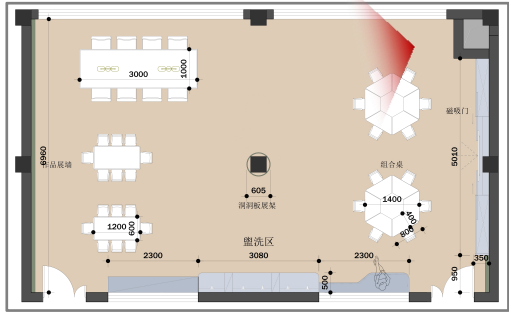



08

Interior floor plan

绘本教室室内平面方案

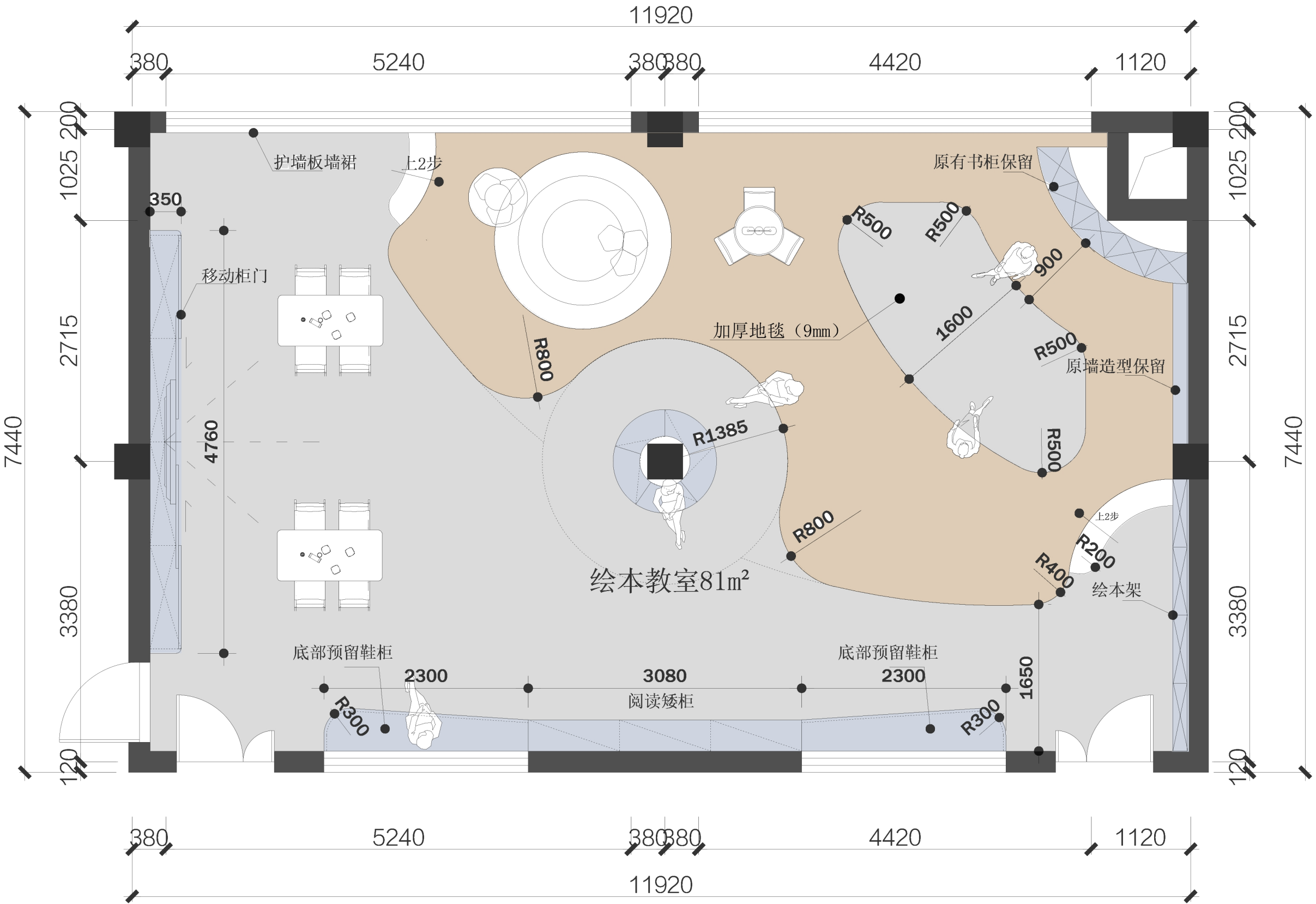







08 In do oreffect  
室内效果

绘本教室  
Doodle Picture Book  
Classroom

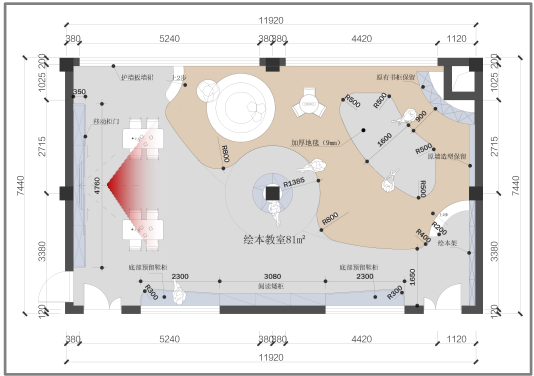



### 厨房及教职工餐厅平面尺寸图

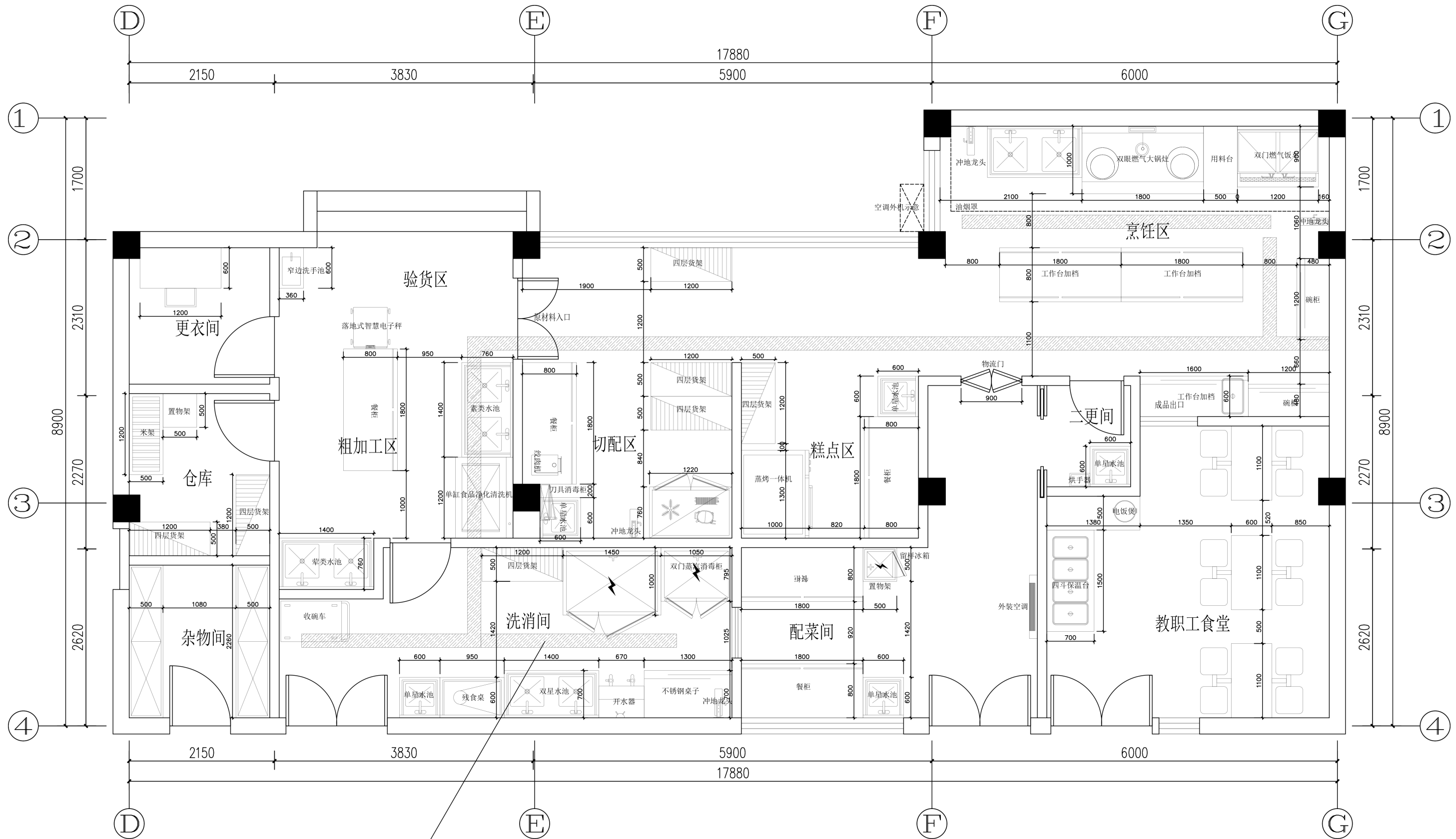

增加一段排水渠

二层弱电机房

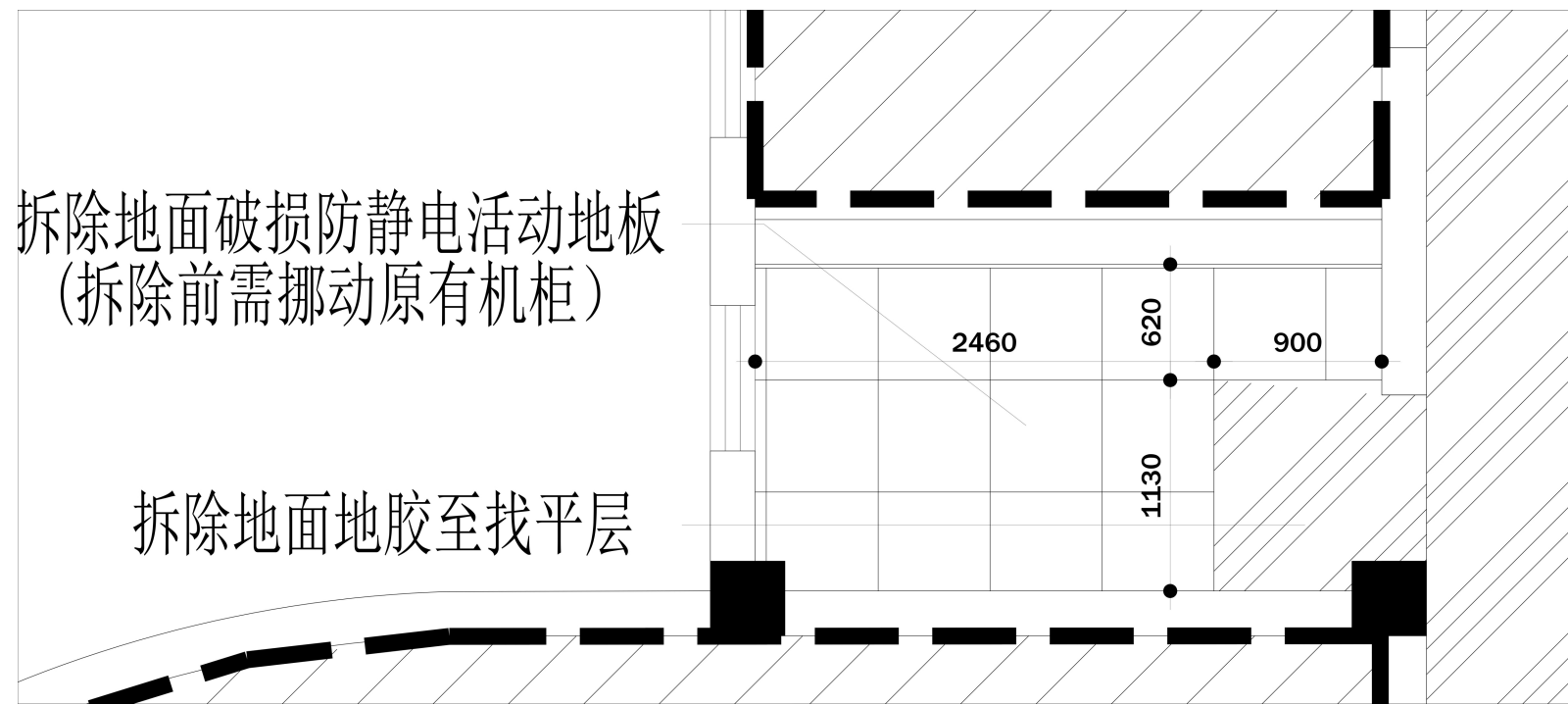

二层弱电机房拆除项目

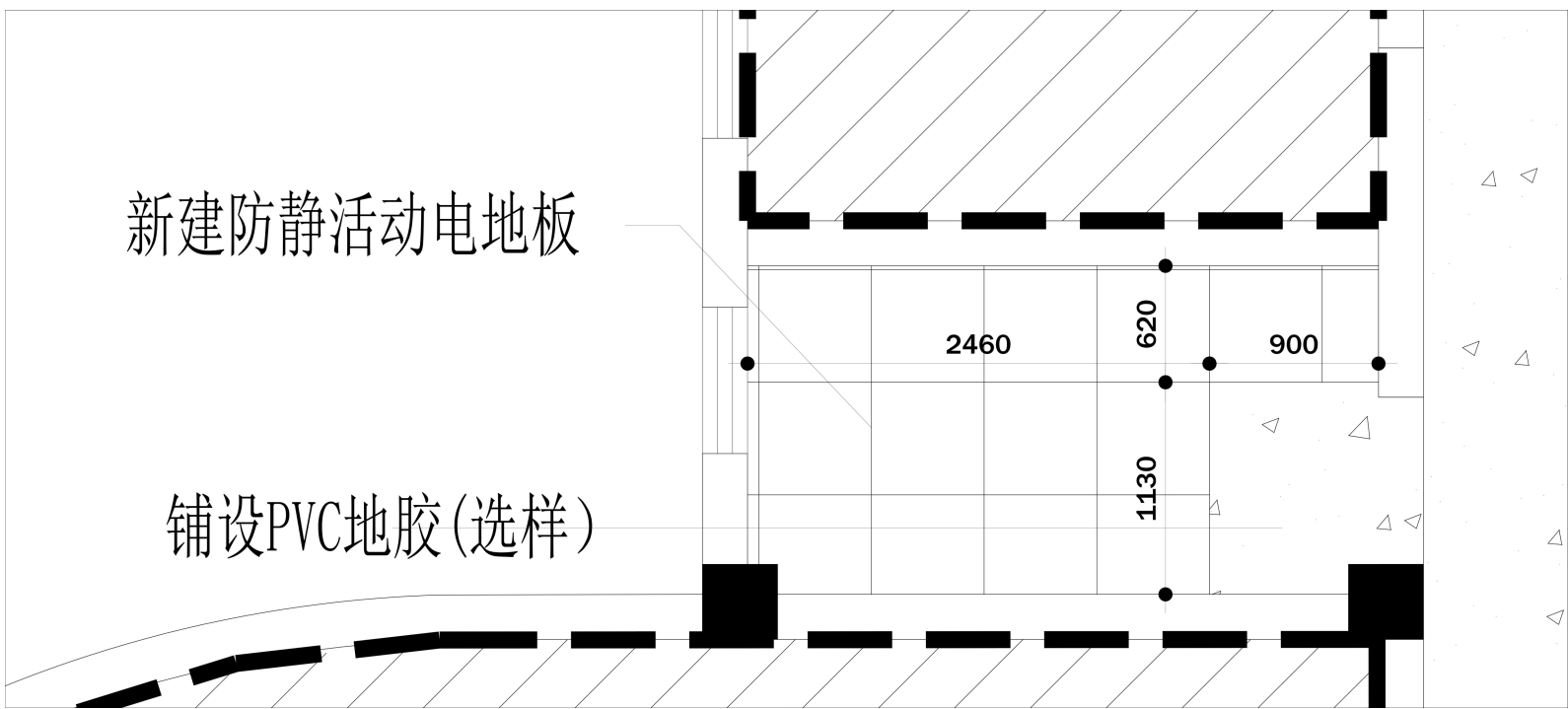

二层弱电机房改造材料及做法

THANK YOU

Yunxin Campus of the Kindergarten Affiliated to Hangzhou Municipal People's Government

杭州市人民政府机关幼儿园运新园区---效果方案设计